

- GENERAL NOTES**
- All work shown on these plans shall be done in accordance with specifications of the Department of Public Works, City of San Bernardino, California, and the Standard Specifications for Road and Bridge Work, published by the American Association of Highway Engineers, 1931 Edition, as amended.
 - All street opening signs and markings shall be provided and installed as shown on drawings.
 - Percent of obstruction:
 - 15% maximum for this contract.
 - 10% maximum for subsequent work.
 - 5% maximum for subsequent work.
1. All work shown on these plans shall be done in accordance with specifications of the Department of Public Works, City of San Bernardino, California, and the Standard Specifications for Road and Bridge Work, published by the American Association of Highway Engineers, 1931 Edition, as amended.
2. All street opening signs and markings shall be provided and installed as shown on drawings.
3. Percent of obstruction:
- 15% maximum for this contract.
 - 10% maximum for subsequent work.
 - 5% maximum for subsequent work.
4. All work shown on these plans shall be done in accordance with specifications of the Department of Public Works, City of San Bernardino, California, and the Standard Specifications for Road and Bridge Work, published by the American Association of Highway Engineers, 1931 Edition, as amended.
5. All work shown on these plans shall be done in accordance with specifications of the Department of Public Works, City of San Bernardino, California, and the Standard Specifications for Road and Bridge Work, published by the American Association of Highway Engineers, 1931 Edition, as amended.
6. All work shown on these plans shall be done in accordance with specifications of the Department of Public Works, City of San Bernardino, California, and the Standard Specifications for Road and Bridge Work, published by the American Association of Highway Engineers, 1931 Edition, as amended.

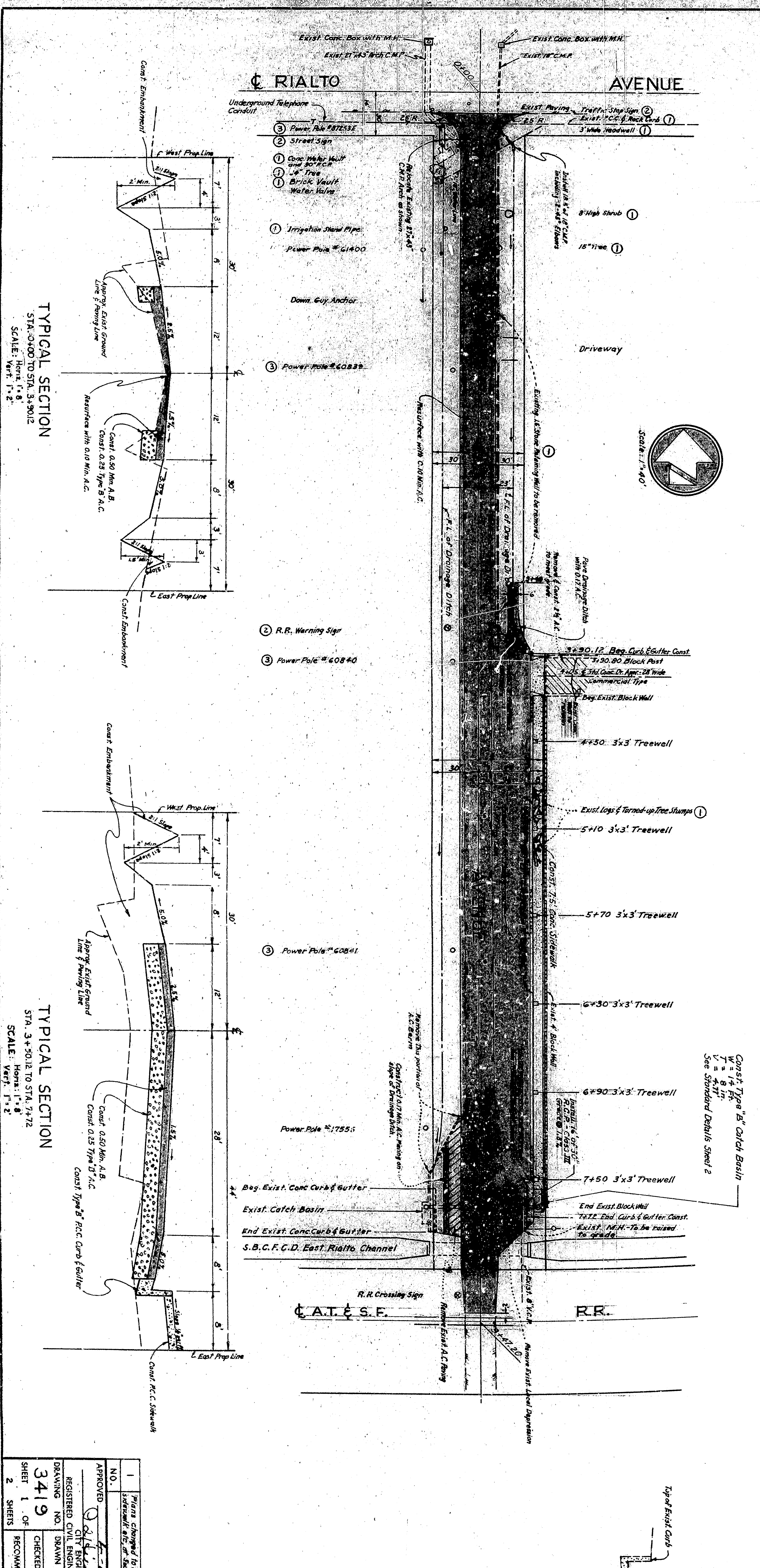

TYPICAL SECTION
STA. 7+00 TO STA. 7+30
SCALE: HORIZ. 1" = 8'
VERT. 1" = 2'

TYPICAL SECTION
STA. 3+50 TO STA. 7+22
SCALE: HORIZ. 1" = 8'
VERT. 1" = 2'

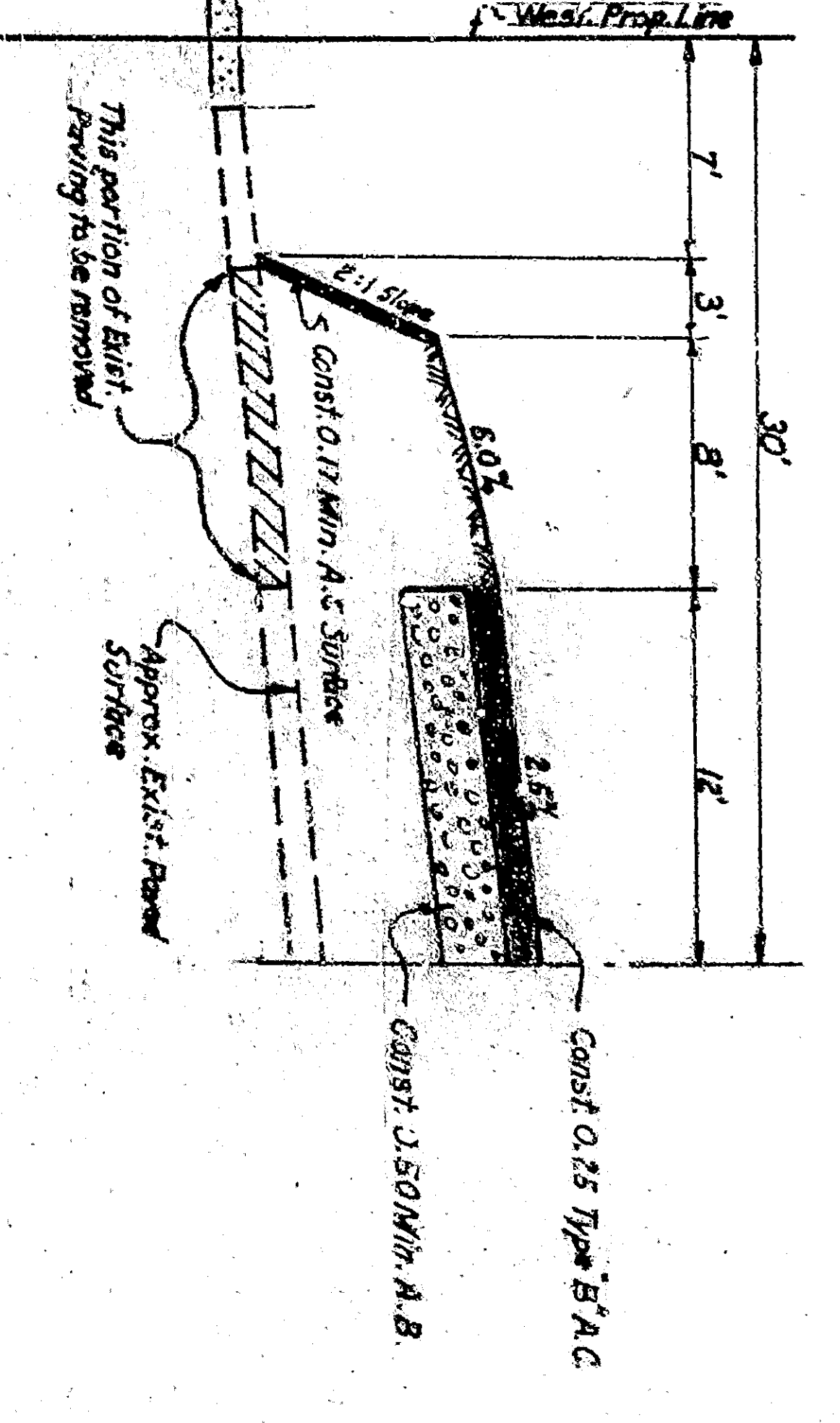

TYPICAL SECTION
STA. 7+50 TO STA. 7+90
SCALE: HORIZ. 1" = 8'
VERT. 1" = 2'

NO.	REVISION	DATE
1	As shown in field notes of survey, 1962, from station 7+00 to 7+30.	7/17/62
2	As shown in field notes of survey, 1962, from station 7+30 to 7+90.	7/17/62

APPROVED: *[Signature]* 7/17/62
 REGISTERED PROFESSIONAL ENGINEER NO. 12643
 DRAWING NO. 3419
 CHECKED BY: DEON
 RECOMMENDED: *[Signature]*

CITY OF SAN BERNARDINO
 DEPARTMENT OF ENGINEERING
 STREET IMPROVEMENTS
 PEPPER AVENUE
 FROM RIALTO AVENUE SOUTH TO
 AT & S.F. R.R. TRACKS